

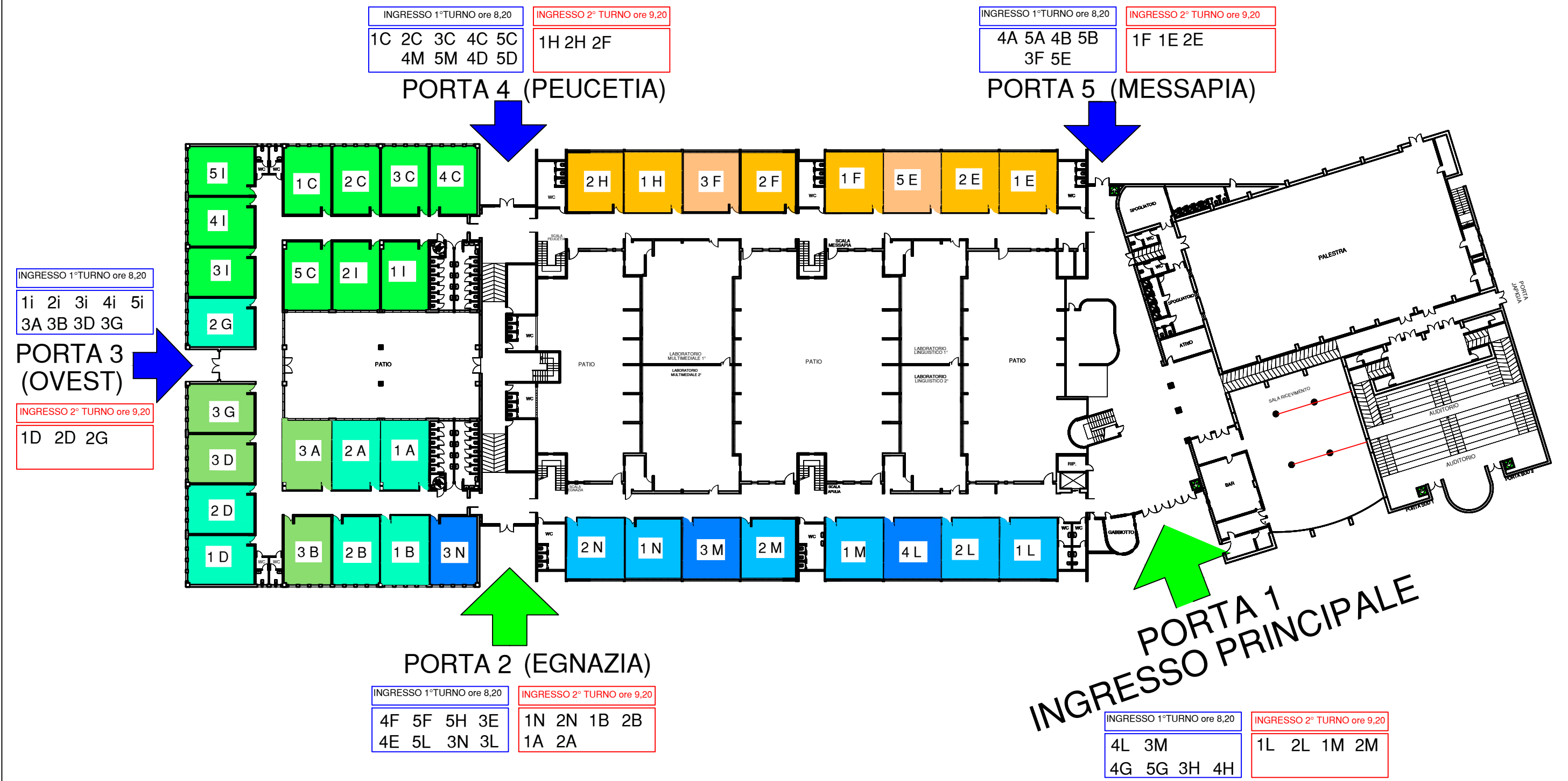









PLANIMETRIA DELL'EDIFICIO SCOLASTICO CON INDIVIDUAZIONE DEGLI ACCESSI E UBICAZIONE DELLE AULE - PIANO TERRA

Allegato 2

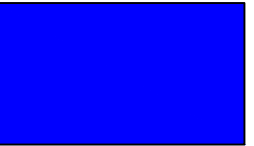

 LICEO CLASSICO (COMPLETO)	 BIENNIO LICEO SCIENTIFICO	 TRIENNIO LICEO SCIENTIFICO
 BIENNIO SCIENZE APPLICATE	 TRIENNIO SCIENZE APPLICATE	
 BIENNIO LINGUISTICO	 TRIENNIO LINGUISTICO	

 INGRESSI CANCELLO OVEST	 INGRESSO CANCELLO PRINCIPALE
---	--